

# ZWBPD006006

## 齿轮箱规格 Gearbox Specifications

外径	Outer diameter	6mm	轴承	Bearing	含油轴承	Porous bearing	滚动轴承	Rolling bearing
材质	Material	塑料 Plastic	轴向窜动	Axial endplay	≤0.3mm		≤0.3mm	
旋转方向	Direction of rotation	cw & ccw	输出轴径向负载	Radial loading on output shaft	≤0.3N		≤4N	
齿轮箱回程差	Gear backlash	≤3°	工作温度	Operating temperature range	-20 ~ +85°C			

## 齿轮级数 Gearbox Stages

		1	2	3	4
减速比	Reduction ratio	5 / 6	23 / 31 / 41	110 / 148 / 198 / 266	531 / 711 / 952 / 1275 / 1708
最大容许扭力 (gf.cm)	Max rated torque of gearbox (gf.cm)	250	250	250	250
瞬间容许力矩 (gf.cm)	Instant torque of gearbox (gf.cm)	600	600	600	600
齿轮箱效率 (%)	Gearbox efficiency (%)	85	72	57	49
长度 (mm)	Gearbox length L1 (mm)	9.7	12.1	14.5	16.9

## 技术插图 | Technical Drawing

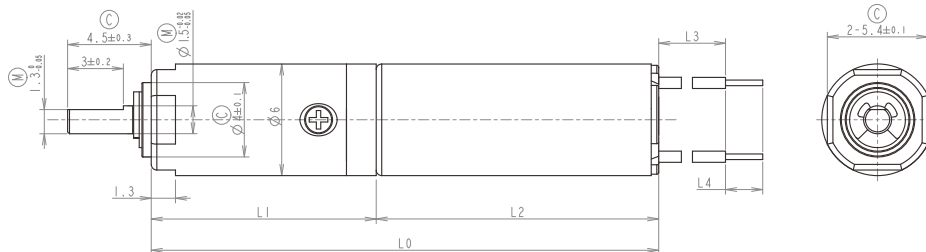

## 马达规格参数 Motor Specifications

马达(可选择)	Motor type (optional)	空心杯电机、步进电机 Coreless motor, Stepper motor	输入速度	Input speed	≤3000rpm
电压(可选择)	Voltage (optional)	3-12V	电流	Current	100mA max

型号 Model	Rated Speed 额定转速	Max Speed 最高转速	Max Rated Torque 额定容许力矩	Max Instant Torque 瞬间容许力矩	ReductionRatio 减速比	Gearbox Length 减速箱长 L1	Overall Length 总长 L
	rpm	rpm	gf.cm	gf.cm		mm	mm
ZWBPD006006-5	1563	6250	250	600	4.8	9.7	23.7
ZWBPD006006-6	1166	4666	250	600	6.43		
ZWBPD006006-23	326	1302	250	600	23.04	12.1	26.1
ZWBPD006006-31	243	972	250	600	30.86		
ZWBPD006006-41	181	726	250	600	41.33		
ZWBPD006006-110	68	271	250	600	110.6	14.5	28.5
ZWBPD006006-148	51	203	250	600	148.1		
ZWBPD006006-198	38	151	250	600	198.4		
ZWBPD006006-266	28	113	250	600	265.7		
ZWBPD006006-531	14	57	250	600	530.8	16.9	30.9
ZWBPD006006-711	11	42	250	600	711.0		
ZWBPD006006-952	8	32	250	600	952.2		
ZWBPD006006-1275	6	24	250	600	1275.2		
ZWBPD006006-1708	4	18	250	600	1707.9		

注：可根据客户要求定制 Please contact us for customized products