

# PD006006

## 齿轮箱规格 Gearbox Specifications

外径	Outer diameter	6mm	轴承	Bearing	含油轴承 oil-impregnated bearings	滚动轴承 Rolling bearing
材质	Material	塑料 Plastic	轴向窜动	Axial Play	≤0.3mm	≤0.3mm
旋转方向	Direction of rotation	cw & ccw	输出轴径向负载	Radial Load at Output Shaft	≤0.3N	≤4N
齿轮箱回程差	Backlash	≤3°	工作温度	Operating temperature range	-20 ~ +85°C	

## 齿轮级数 Gearbox Stages

		1	2	3	4
减速比	Reduction ratio	5 / 6	23 / 31 / 41	110 / 148 / 198 / 266	531 / 711 / 952 / 1275 / 1708
最大容许扭力 (gf.cm)	Max rated torque of gearbox (gf.cm)	250	250	250	250
瞬间容许力矩 (gf.cm)	Max. intermittent torque (gf.cm)	600	600	600	600
齿轮箱效率 (%)	Gearbox efficiency (%)	85	72	57	49
长度 (mm)	Gearbox length L1 (mm)	9.7	12.1	14.5	16.9

## 技术插图 | Technical Drawing

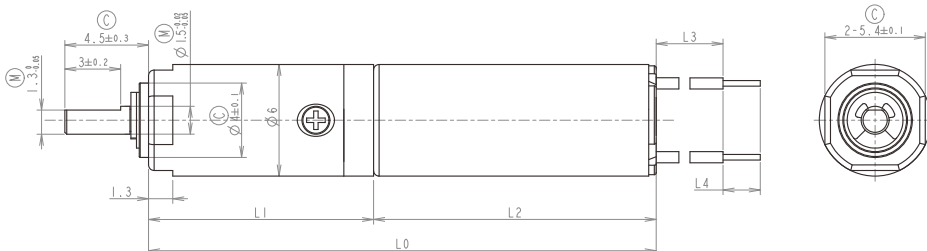

## 马达规格参数 Motor Specifications

马达(可选择) Motor type (optional)	空心杯电机、步进电机 Coreless motor, Stepper motor	输入速度 Input speed	≤30000rpm
电压(可选择) Voltage (optional)	3-12V	负载电流 Load current	100mA max

型号 Model	Rated Speed 额定转速	Max Speed 最高转速	Max Rated Torque 齿轮箱额定容许力矩	Max. Intermittent Torque 齿轮箱瞬间容许力矩	Reduction Ratio 减速比	Gearbox Length 减速箱长 L1	Overall Length 总长 L
	rpm	rpm	gf.cm	gf.cm		mm	mm
PD006006-5	1563	6250	250	600	4.8	9.7	23.7
PD006006-6	1166	4666	250	600	6.43		
PD006006-23	326	1302	250	600	23.04	12.1	26.1
PD006006-31	243	972	250	600	30.86		
PD006006-41	181	726	250	600	41.33		
PD006006-110	68	271	250	600	110.6	14.5	28.5
PD006006-148	51	203	250	600	148.1		
PD006006-198	38	151	250	600	198.4		
PD006006-266	28	113	250	600	265.7		
PD006006-531	14	57	250	600	530.8	16.9	30.9
PD006006-711	11	42	250	600	711.0		
PD006006-952	8	32	250	600	952.2		
PD006006-1275	6	24	250	600	1275.2		
PD006006-1708	4	18	250	600	1707.9		

注:可根据客户要求定制 Specifications can be customized per customer requirements.