

# MD003003

## 齿轮箱规格 Gearbox Specifications

|        |                       |          |         |                             |                               |
|--------|-----------------------|----------|---------|-----------------------------|-------------------------------|
| 外径     | Outer diameter        | 3.4mm    | 轴承      | Bearing                     | 含油轴承 oil-impregnated bearings |
| 材质     | Material              | 五金 Metal | 轴向窜动    | Axial Play                  | ≤0.3mm                        |
| 旋转方向   | Direction of rotation | cw & ccw | 输出轴径向负载 | Radial Load at Output Shaft | ≤0.3N                         |
| 齿轮箱回程差 | Backlash              | ≤3°      | 工作温度    | Operating temperature range | -20 ~ +85°C                   |

| 齿轮级数 Gearbox Stages                                |  | 1   | 2   | 3   | 4    |
|--|--|-----|-----|-----|------|
| 减速比 Reduction ratio                                |  | 5   | 25  | 125 | 625  |
| 最大容许扭力 (gf.cm) Max rated torque of gearbox (gf.cm) |  | 50  | 50  | 50  | 50   |
| 瞬间容许力矩 (gf.cm) Max. intermittent torque (gf.cm)    |  | 150 | 150 | 150 | 150  |
| 齿轮箱效率 (%) Gearbox efficiency (%)                   |  | 85  | 73  | 65  | 58   |
| 长度 (mm) Gearbox length L1 (mm)                     |  | 6   | 7.5 | 9   | 10.5 |

## 技术插图 | Technical Drawing

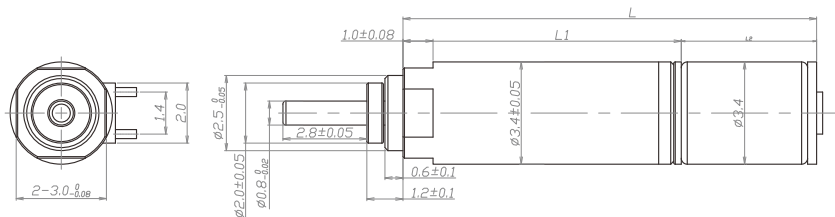

## 马达规格参数 Motor Specifications

|               |                    |                   |           |
|---------------|--------------------|-------------------|-----------|
| 马达 Motor type | 步进电机 Stepper motor | 输入速度 Input speed  | ≤10000rpm |
| 电压 Voltage    | 3V                 | 负载电流 Load current | 50mA max  |

| 型号 Model     | Speed at 2400pps<br>2400pps频率转速 | Max Rated Torque<br>齿轮箱额定容许力矩 | Max. Intermittent Torque<br>齿轮箱瞬间容许力矩 | Reduction Ratio<br>减速比 | Gearbox Length<br>减速箱长 L1 | Overall Length<br>总长 L |
|--------------|---------------------------------|-------------------------------|---------------------------------------|------------------------|---------------------------|------------------------|
|              | rpm                             | gf.cm                         | gf.cm                                 |                        | mm                        | mm                     |
| MD003003-5   | 1440.0                          | 50                            | 150                                   | 5                      | 6.0                       | 10.75                  |
| MD003003-25  | 288.0                           | 50                            | 150                                   | 25                     | 7.5                       | 12.25                  |
| MD003003-125 | 57.6                            | 50                            | 150                                   | 125                    | 9.0                       | 13.75                  |
| MD003003-625 | 11.5                            | 50                            | 150                                   | 625                    | 10.5                      | 15.25                  |

注:可根据客户要求定制 Specifications can be customized per customer requirements.